



The art of power and perfection



PNEUMATIC AND HYDRAULIC ACTUATORS





The art of power and perfection

ACTREG, established in 1992, is a multinational company specializing in the manufacture and sales of high quality actuators for valves requiring a rotary quarter turn movement for either On/Off or modulating duty. The expertise and know how has made ACTREG leader in actuation technology.



ACTREG provides world coverage thanks to the strategic locations of its factories and offices. The international distribution ensures quick availability and more important, personalized service for valve manufacturers, valve stocking distributors and contractors.

ESTABLISHED IN

1992

INTERNATIONAL

Distribution

DESIGN &

Quality

PERSONALIZED

Service



The art of power and perfection

SCOTCH YOKE
Heavy duty service

TORQUES UP TO
250,000 Nm

ACTUATORS IN
25 different sizes

We are a manufacturer of rack and pinion aluminium housing actuators with torque figures up to 6.500 Nm and scotch yoke actuators for heavy duty service up to 250,000 Nm. Our products offer reliable and dependable automation for ¼ turn valves.

Engineered and built to withstand most of the applications and environmental conditions, the precision in design and quality provides a long and safe operational performance in valve control.

ACTREG has invested in quality assurance, state-of-the-art machining and testing facilities in order to assist customers in safely controlling their processes.

ACTREG engineers are happy to help you with your automation requirements.

The art of power and po



RACK AND PINION
Aluminium housing

TORQUES UP TO
6.500 Nm

ACTUATORS IN
14 different sizes

Certificates

ACTREG, S.A. has a Quality Management System certified in accordance with the requirements of ISO 9001:2008 for the design, development, manufacturing and distribution of pneumatic actuators and accessories for valves. Certified by BVQI No. ESPMDD005463.

In accordance with the requirements of pressure equipment directive 97/23/EC, Actreg scotch yoke actuators are classified as follows:

SY01F14 200 - Category SEP, procedure module H1

SY01F14 250 up to SY01F25 400 - Category I, procedure module H1

SY01F25 450 up to SY01F40 600 - Category II, procedure module H1

SY01F40 700 up to SY01F60 900 - Category III, procedure module H1

SY01F60 1000 up to SY01F60 1100 - Category IV, procedure module H1

All ACTREG pneumatic actuators are classified for use in potentially explosive atmospheres as Group II Category 2, suitable for zones 1, 2, 21 and 22 in accordance with Annex VIII of Directive 94/9/CE (ATEX). Technical file is deposited to LCIE, No. LCIE 11 AR 011.

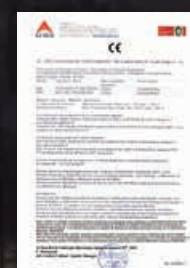
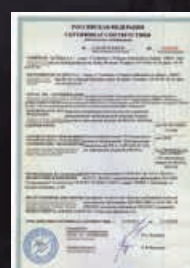

erfection

MAIN FEATURES & CHARACTERISTICS

Hydraulic pressure
Up to 100 barg (1449 psig)

Pneumatic pressure
Up to 10 barg (145 psig)

Torque output
Up to 250.000 Nm (184.229 lbf-in)

Temperature ranges

- Standard -20° C to 80 °C
- Low Temperature -40 °C to 80 °C
- High Temperature -20 °C to 120 °C

Other range of temperatures under request

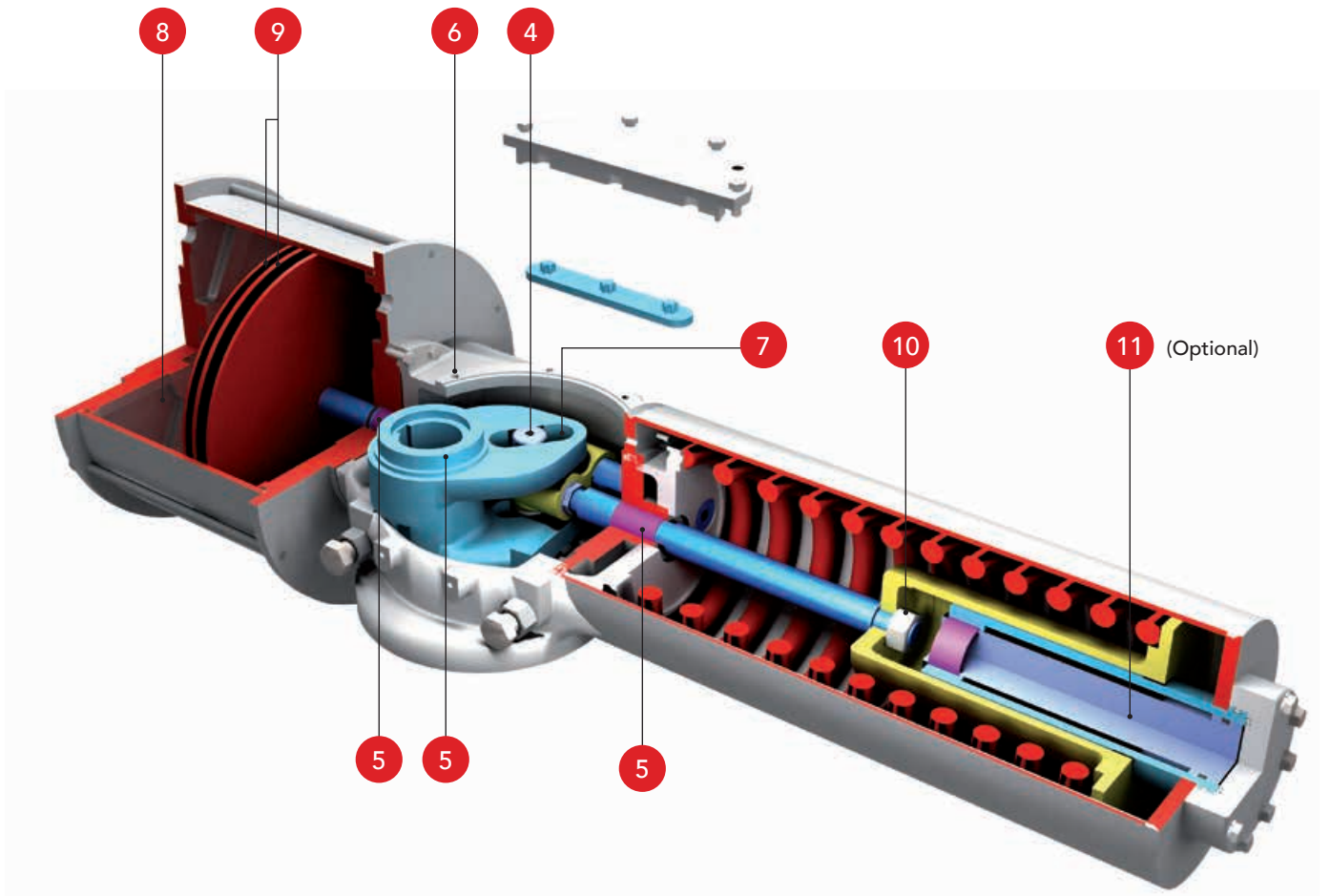
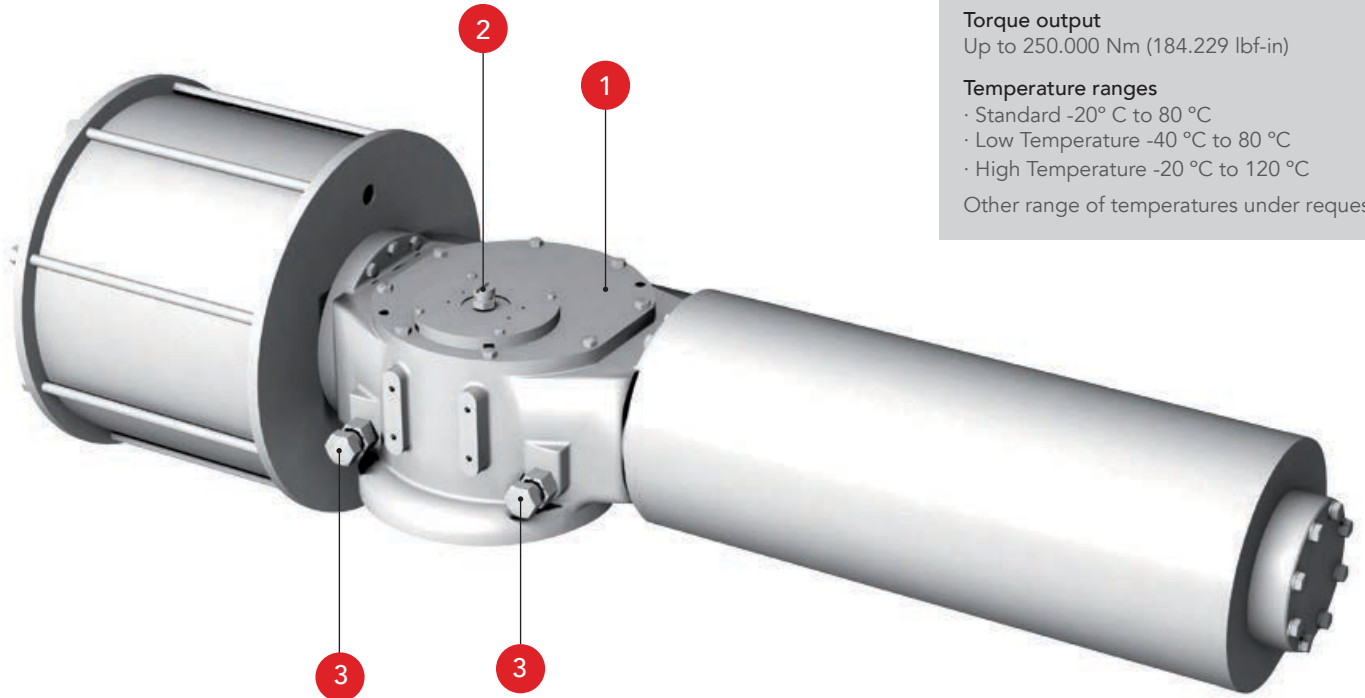

BODY

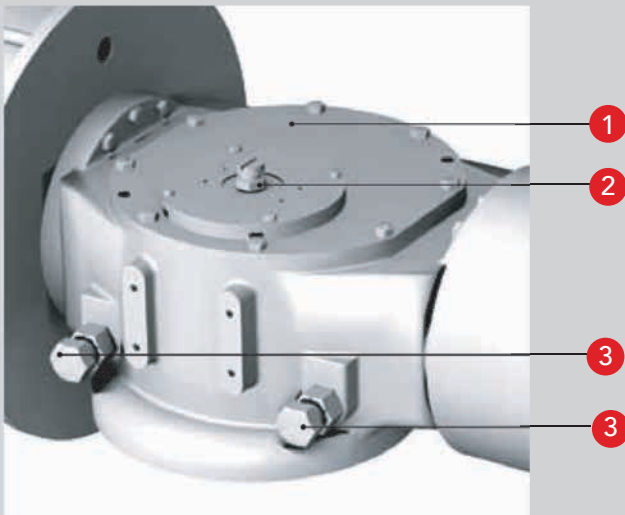

- + 8 different sizes from F14 (2000 Nm) up to F60 (250.000 Nm).
- 1 Internal O-rings to ensure water ingress protection.
- 2 NAMUR standard for all sizes for assembly of switch boxes and positioners.
- 3 Threaded parts in front and the back side of the body for easy assembly of a pneumatic control panel.

INTERNAL BODY PARTS

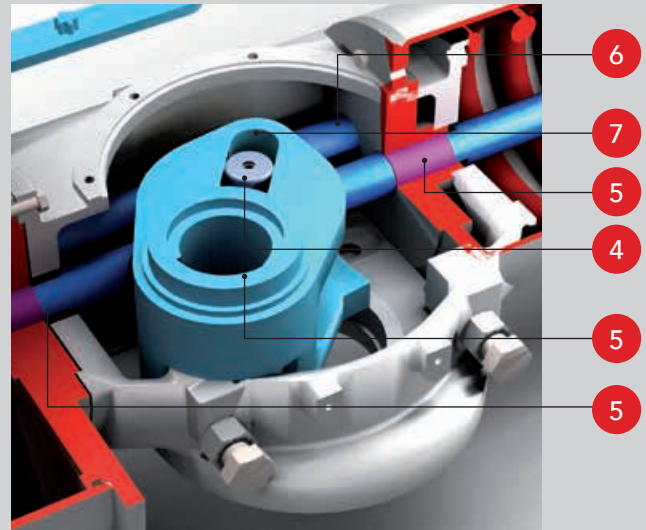

- 4 Round rolled is used, reducing the friction between the yoke arm and pin, minimizing the wear.
- 5 Replaceable bearings protect the sliding and rotating components, suitable for either dry or lubricated working conditions.
- 6 PTFE thrust bar prevents yoke pin axial movement, transferring axial loads directly to the drive module case.
- 7 Yoke connects the piston rod with the guide block, compensating for side load deflection and reducing wear on rod, bearings and seals.

PNEUMATIC CYLINDER

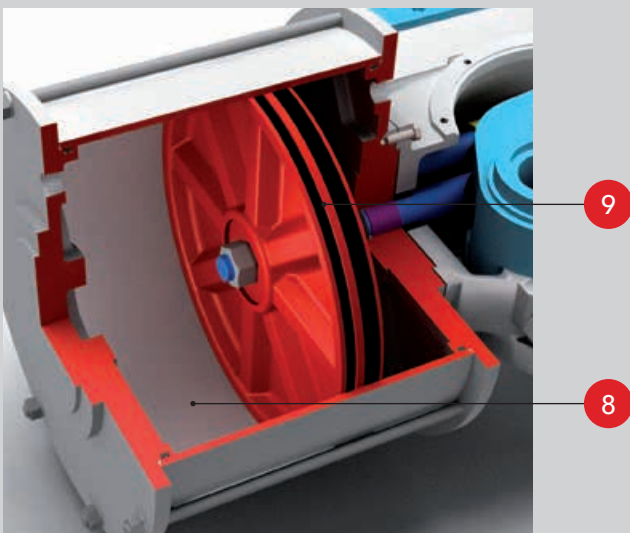

- 8 **PNEUMATIC CYLINDER**
The inner surface of cylinder is coated with PTFE, to prevent resistance and self-lubricating.
- 9 **PISTONS SEALS**
Double sealing, with O-ring seal and dynamic guide ring to prevent metal to metal contact between the piston and the cylinder.

SPRING MODULE

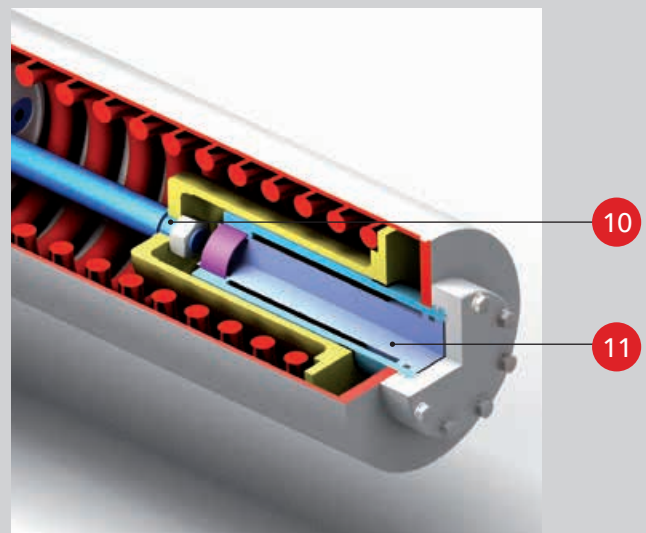

- 10 Safe spring Lock, prevents spring module detachment from the drive module.
- 11 Internal Hydraulic cylinder for manual pump override. (Optional).

CHARACTERISTICS & FEATURES

Versatility

Every ACTREG SY series actuator is built to provide long end efficient service with minimum maintenance. The design, engineering and materials used in their construction ensure optimum performance even in the hardest environments.

Totally enclosed weatherproof centre-body and caps provided with o-rings to ensure the water ingress protection.

The centre-body has a guide that supports transverse forces of the scotch and yoke mechanism and ensures proper alignment of the piston rod.

External travel stop screws allow a precise valve angular stroke adjustment between 80° to 100°.

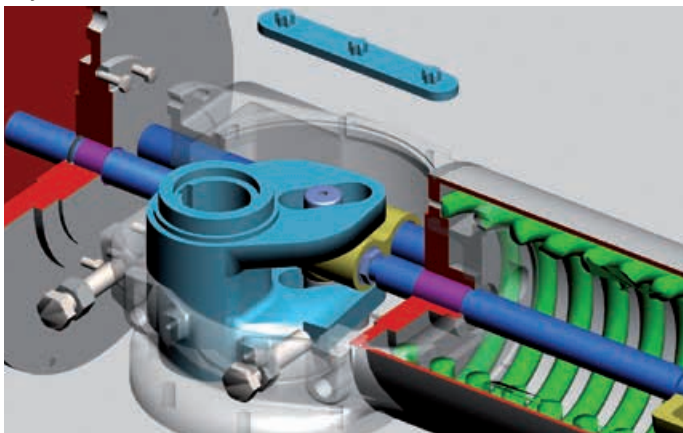

The SY actuators are manufactured in many different combinations of actuator sizes, cylinder diameters, and double or spring return action is available for installation on ¼ turn valves. SY actuators are designed for use over a wide range of pressures or temperatures.

The scotch and yoke mechanism is available in symmetric design offering a more constant torque with minimum cost and weight.

The SY actuator is a modular design. A pneumatic or hydraulic cylinder can be attached, to either side or both sides. With a large stock of finished and semi-finished components always available, actuators can be assembled and supplied with very fast and reliable deliveries.

Symmetric yoke mechanism
Spring to close

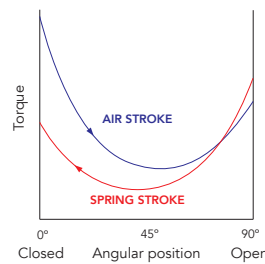

Symmetric yoke mechanism
Spring to open

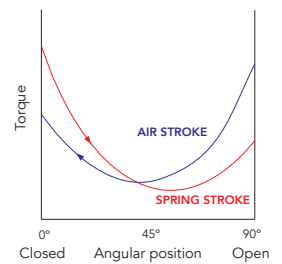

Modular versatility

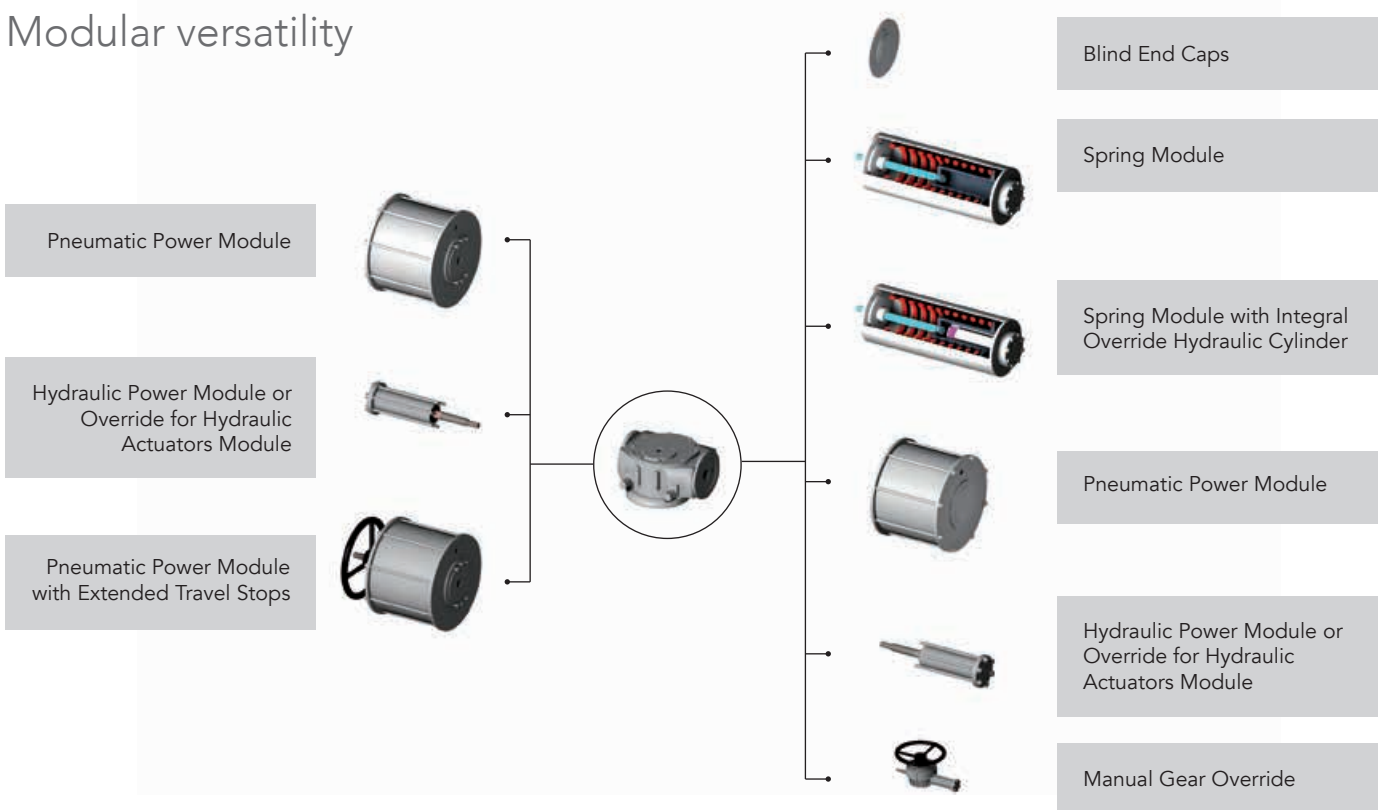

SY series actuators are the module-in design which consists of the different module. The different functions is available in the different combinations.

Manual Override options

The manual override is an important requirement for many valve/actuator applications. In case that air fails, the user will be able to open or close the valve manually.

ACTREG has a variety of override options available to meet any requirement. Available options include jackscrew, hydraulic manual override and sandwich type override. We also offer solutions in tank reservoir systems.



Hydraulic Manual
Override (HY)

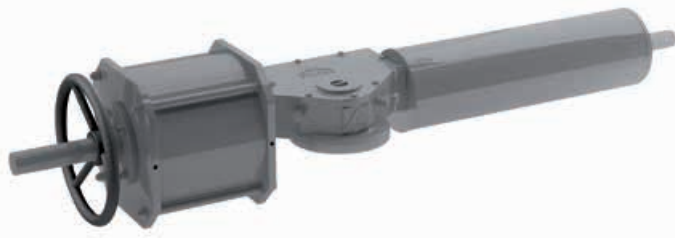

Jackscrew Manual
Override (HW)



Declutchable Gears Sandwich type

Control panels and specific solutions

Pneumatic packages, solenoid valves and so on, are part of any actuator/valve installation. Actreg has extensive experience in the design and assembly of all types of fluid poser control systems to satisfy any customer requirements. Our engineers have a deep knowledge of controls and pneumatic or hydraulic systems.

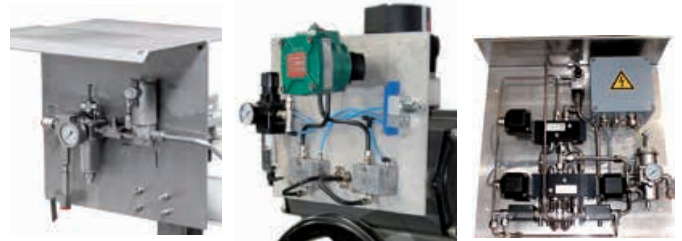

Passive fire protections



Passive fire protection is a key issue in the safety of hydrocarbon process plants. It is considered a reliable method to reduce plant fire risks. For this matter, ACTREG actuators can be customized to withstand exposure to fire and very high temperatures. A full range of fire proof systems is available, including protective jackets, intumescent coatings and stainless steel enclosure systems.



PARTS & MATERIALS

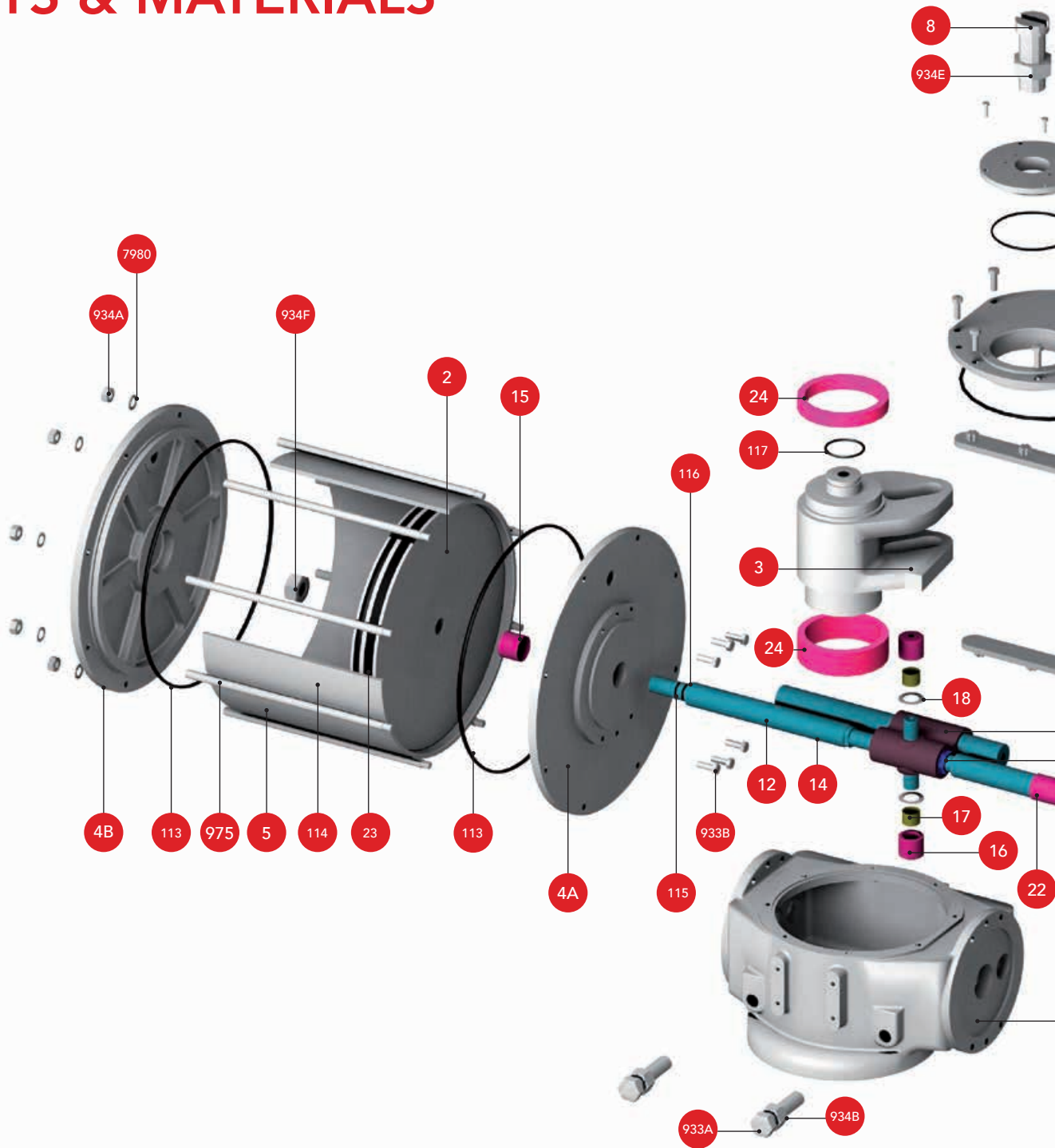

- | | | | |
|--------------------------------------|--|--|------------------------------------|
| 1 Body
Ductil iron | 6 Body cover
Ductil iron | 13 Tension rod
Alloy steel chromium plated | 19 Spring
Aloy steel |
| 2 Piston
Ductil iron | 7 Shaft cover
Ductil iron | 14 Center guide bar
Alloy steel chromium plated | 20 Guide block
Ductil iron |
| 3 Yoke
Carbon steel | 8 Drive shaft
Stainless steel | 15 Sliding bearing
Metal + PTFE | 21 Cover plate
Carbon steel |
| 4A End cap
Carbon steel | 10 Supported guide
Carbon steel | 16 Roller sliding bearing
Metal + PTFE | 22 Sliding bearing
Metal + PTFE |
| 4B End cap
Carbon steel | 11 Spring cylinder
Carbon steel | 17 Roller
Alloy steel | 23 Guide ring
PTFE |
| 5 Pneumatic cylinder
Carbon steel | 12 Center bar
Alloy steel chromium plated | 18 Block washer
Stainless steel | 24 Sliding bearing
Metal + PTFE |

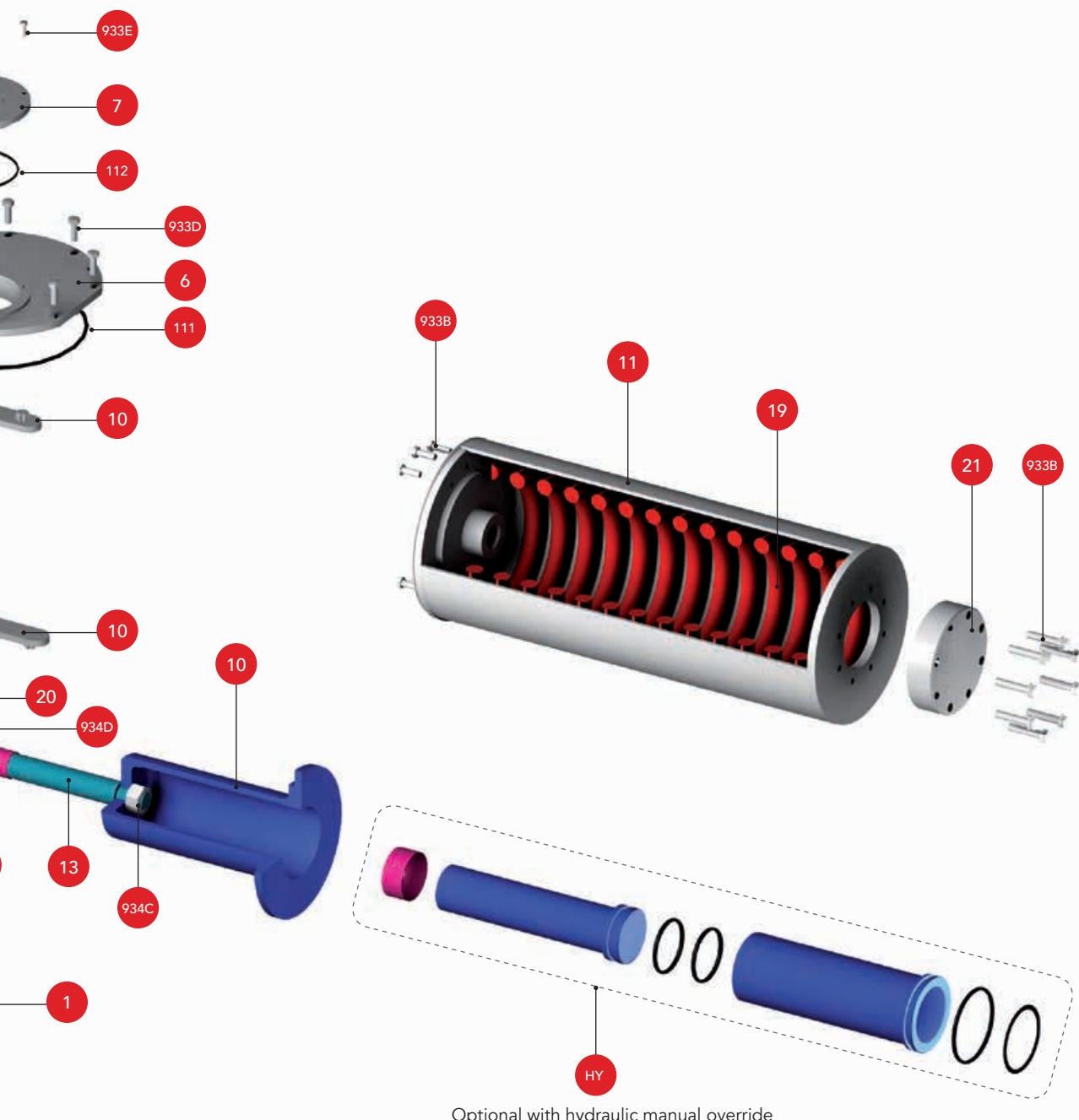

Optional with hydraulic manual override

- 111 Oring NBR
- 112 Oring NBR
- 113 Oring NBR
- 114 Oring NBR
- 115 Oring NBR
- 116 O-ring NBR

- 117 Oring NBR
- 933A Nut Carbon steel
- 933B Screw Carbon steel
- 934C Screw Carbon steel
- 933D Screw Carbon steel
- 933E Screw Carbon steel

- 934A Nut Carbon steel
- 934B Adjustment screw Carbon steel
- 934C Nut Carbon steel
- 934D Nut Carbon steel
- 934E Nut drive shaft Stainless steel
- 934F Spring nut Carbon steel

- 975 Screw Carbon steel
- 7980 Gland nut Carbon steel
- HY Orings NBR
- Sliding bearing Metal + PTFE
- Hydraulic cylinder Carbon steel
- Piston Carbon steel

ACTREG SY SERIES

SINGLE ACTING		DOUBLE ACTING		AIR INLET SIZE	
Series	Air volume Volume (L)	Series	Air volume Volume (L)	Air inlet size table	
				Cylinder	Air inlet size
SY01F14-250 SRX	4	SY01F14-250 DA	8.1	200	3/8"
SY01F14-300 SRX	6.4	SY01F14-300 DA	12.9	250	1/2"
SY01F14-350 SRX	9.2	SY01F14-350 DA	15.7	300	1/2"
SY01F16-250 SRX	8	SY01F16-250 DA	16	350	1/2"
SY01F16-300 SRX	11.5	SY01F16-300 DA	18.4	400	3/4"
SY01F16-350 SRX	15.5	SY01F16-350 DA	21.9	450	3/4"
SY01F25-350 SRX	19	SY01F25-350 DA	38	500	3/4"
SY01F25-400 SRX	25	SY01F25-400 DA	50	550	3/4"
SY01F25-450 SRX	32	SY01F25-450 DA	64	600	1"
SY01F30-450 SRX	38	SY01F30-450 DA	76	700	1"
SY01F30-500 SRX	47	SY01F30-500 DA	94	800	1 1/2"
SY01F30-550 SRX	57	SY01F30-550 DA	114	900	2"
SY01F35-550 SRX	72	SY01F35-550 DA	144	1000	2"
SY01F35-600 SRX	86	SY01F35-600 DA	172	1100	2"
SY01F35-700 SRX	118	SY01F35-700 DA	236		
SY01F40-600 SRX	104	SY01F40-600 DA	208		
SY01F40-700 SRX	143	SY01F40-700 DA	286		
SY01F40-800 SRX	186	SY01F40-800 DA	372		
SY01F48-800 SRX	216	SY01F48-800 DA	432		
SY01F48-900 SRX	274	SY01F48-900 DA	548		
SY01F48-1000 SRX	338	SY01F48-1000 DA	676		
SY01F60-800 SRX	291	SY01F60-800 DA	582		
SY01F60-900 SRX	369	SY01F60-900 DA	738		
SY01F60-1000 SRX	455	SY01F60-1000 DA	910		
SY01F-60-1100 SRX	551	SY01F60-1100 DA	1102		

PNEUMATIC CYLINDER AIR CONNECTION & HIDRAULIC CONNECTION

PNEUMATIC ACTUATOR

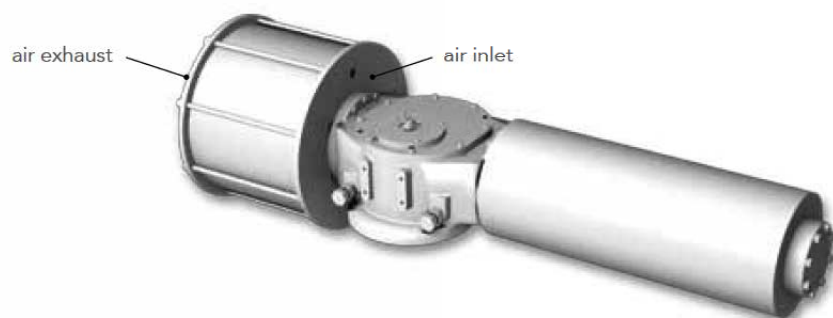

HYDRAULIC ACTUATOR

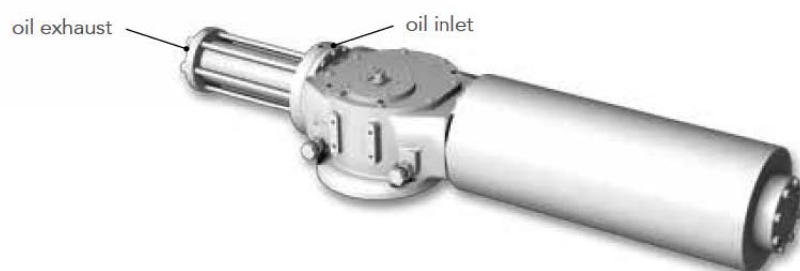

TORQUE & DIMENSIONS

DOUBLE ACTING

TORQUE SHEET

Series	Flange	3 bar		4 bar		5 bar		6 bar		7 bar	
		Start - End	Running	Start - End	Running	Start - End	Running	Start - End	Running	Start - End	Running
SY01F14-200 DA	F14	822	499	1096	665	1370	831	1643	997	1918	1163
SY01F14-250 DA		1285	779	1713	1039	2141	1299	0	0	0	0
SY01F14-300 DA		1842	1118	0	0	0	0	0	0	0	0
SY01F16-250 DA	F16	1590	964	2120	1286	2650	1607	3180	1929	3710	2250
SY01F16-300 DA		2289	1389	3053	1851	3816	2315	-	-	-	-
SY01F16-350 DA		3116	1890	4155	2521	-	-	-	-	-	-
SY01F25-350 DA	F25	3847	2333	5130	3112	6412	3890	7695	4668	-	-
SY01F25-400 DA		4884	2963	6513	3950	8141	4938	-	-	-	-
SY01F25-450 DA		6183	3750	8244	5001	-	-	-	-	-	-
SY01F30-450 DA	F30	7556	4583	10074	6111	12328	7478	15112	9167	-	-
SY01F30-500 DA		9329	5659	12439	7546	15549	9433	-	-	-	-
SY01F30-550 DA		11289	6848	15052	9131	-	-	-	-	-	-
SY01F35-550 DA	F35	14367	8715	19156	11621	23944	14526	28734	17431	33523	20337
SY01F35-600 DA		17098	10372	22798	13830	28496	17287	34196	20746	-	-
SY01F35-700 DA		23273	14119	31031	18825	-	-	-	-	-	-
SY01F40-600 DA	F40	20762	12595	27683	16793	34604	20993	41526	25192	48446	29390
SY01F40-700 DA		28259	17143	37680	22859	47101	28574	56521	34288	65940	40004
SY01F40-800 DA		36911	22392	49215	39559	61519	37320	-	-	-	-
SY01F48-800 DA	F48	43425	26343	57899	35125	72375	43907	86851	52689	101325	61471
SY01F48-900 DA		54959	33342	73280	44456	91599	55569	109919	66683	128239	77797
SY01F48-1000 DA		67852	41163	90470	54885	113087	68606	-	-	-	-
SY01F60-800 DA	F60	58624	35174	78166	46899	97707	58625	117248	71130	136789	82985
SY01F60-900 DA		74196	45011	98928	60016	123659	75020	148392	90024	173124	105028
SY01F60-1000 DA		91600	55570	122133	74094	152666	92617	183200	111141	213733	129664
SY01F60-1100 DA		110835	67240	147781	89653	184726	112067	221671	134480	258616	156893

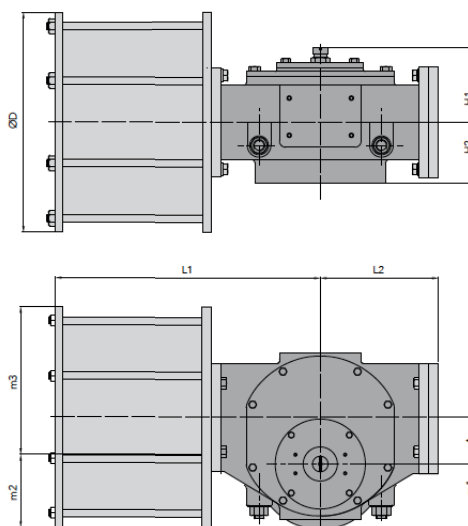
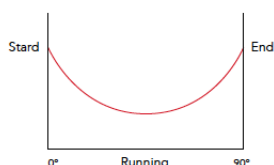

DIMENSIONS

Series	Dimensions in mm									
	L1	L2	H1	H2	Ø D	A	m1	m2	m3	
SY01F14-200 DA	423	165	114	87	256	60	89	68	188	
SY01F14-250 DA	423	165	114	87	310	60	89	95	215	
SY01F14-300 DA	423	165	114	87	365	60	89	122,5	242,5	
SY01F16-250 DA	499	190	119	98	310	75	105	80	230	
SY01F16-300 DA	499	190	119	98	365	75	105	107,5	257,5	
SY01F16-350 DA	499	190	119	98	415	75	105	132,5	282,5	
SY01F25-350 DA	582	222	130	104	415	90	150	117,5	297,5	
SY01F25-400 DA	582	222	130	104	465	90	150	172,5	322,5	
SY01F25-450 DA	582	222	130	104	516	90	150	168	348	
SY01F30-450 DA	705	287	153	129	516	110	175	148	368	
SY01F30-500 DA	705	287	153	129	570	110	175	175	395	
SY01F30-550 DA	705	287	153	129	620	110	175	200	420	
SY01F35-550 DA	832	326	165	149	620	140	207,5	170	450	
SY01F35-600 DA	832	326	165	149	670	140	207,5	195	475	
SY01F35-700 DA	832	326	165	149	772	140	207,5	246	526	
SY01F40-600 DA	970	388	182	176	670	170	237,5	165	505	
SY01F40-700 DA	970	388	182	176	772	170	237,5	216	556	
SY01F40-800 DA	970	388	182	176	878	170	237,5	269	609	
SY01F48-800 DA	1130	440	230	222	878	200	280	239	639	
SY01F48-900 DA	1130	440	230	222	980	200	280	290	690	
SY01F48-1000 DA	1130	440	230	222	1080	200	208	340	740	
SY01F60-800 DA	1420	3150	240	225	878	270	343	169	709	
SY01F60-900 DA	1420	3150	240	225	980	270	343	220	760	
SY01F60-1000 DA	1420	3150	240	225	1080	270	343	270	810	
SY01F60-1100 DA	1420	3150	240	225	1180	270	343	320	860	

TORQUE & DIMENSIONS

SPRING RETURN SR3

TORQUE SHEET

Series	Flange	Output torque air pressure 3 bar			Output torque Springs		
		Air break	Air running	Air end	Spring break	Spring running	Spring end
SY01F14-200 SR3	F14	518	258	315	506	251	304
SY01F14-250 SR3		783	399	503	781	398	501
SY01F14-300 SR3		1182	609	782	1068	538	667
SY01F16-250 SR3	F16	1056	508	524	1081	503	601
SY01F16-300 SR3		1430	720	893	1420	714	883
SY01F16-350 SR3		2024	1028	1270	1877	958	1215
SY01F25-350 SR3	F25	2323	1242	1551	2227	1141	1455
SY01F25-400 SR3		3058	1558	1884	2966	1501	1876
SY01F25-450 SR3		3736	1879	2325	3920	1993	2509
SY01F30-450 SR3	F30	4773	2377	2895	4738	2355	2860
SY01F30-500 SR3		5924	2903	3440	5984	2939	3500
SY01F30-550 SR3		7097	3627	4604	6798	3442	4306
SY01F35-550 SR3	F35	9167	4523	5425	9088	4475	5346
SY01F35-600 SR3		10958	5371	6366	10906	5338	6314
SY01F35-700 SR3		14692	7408	9205	14305	7168	8818
SY01F40-600 SR3	F40	12940	6484	7973	13000	6520	8033
SY01F40-700 SR3		18378	9527	12352	16195	8173	10169
SY01F40-800 SR3		23758	12335	16076	21212	10770	13529
SY01F48-800 SR3	F48	27651	14001	17514	26353	13197	16217
SY01F48-900 SR3		34901	17644	22015	33506	16779	20619
SY01F48-1000 SR3		39739	19515	23213	45331	22983	28806
SY01F60-800 SR3	F60	35441	18195	21587	36432	18293	22577
SY01F60-900 SR3		47388	23465	28306	46647	23006	27564
SY01F60-1000 SR3		54655	26172	29770	62764	31199	37878
SY01F60-1100 SR3		63242	34913	33877	78089	34505	48725

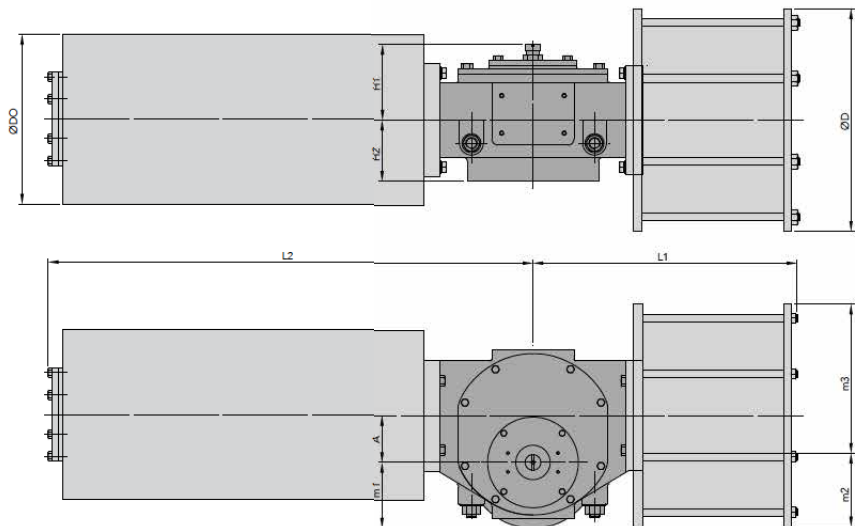
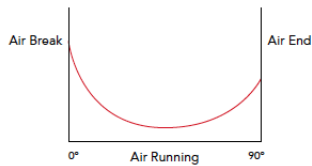

DIMENSIONS

Series	Dimensions in mm									
	L1	L2	H1	H2	Ø D	Ø DD	A	m1	m2	m3
SY01F14-200 SR3	423	618	114	87	256	219	60	89	68	188
SY01F14-250 SR3	423	618	114	87	310	273	60	89	95	215
SY01F14-300 SR3	423	618	114	87	365	273	60	89	122,5	242,5
SY01F16-250 SR3	499	775	119	98	310	219	75	105	80	230
SY01F16-300 SR3	499	775	119	98	365	273	75	105	107,5	257,5
SY01F16-350 SR3	499	775	119	98	415	273	75	105	132,5	282,5
SY01F25-350 SR3	582	935	130	104	415	273	90	150	117,5	297,5
SY01F25-400 SR3	582	935	130	104	465	325	90	150	172,5	322,5
SY01F25-450 SR3	582	935	130	104	516	325	90	150	168	348
SY01F30-450 SR3	705	1210	153	129	516	377	110	175	148	368
SY01F30-500 SR3	705	1210	153	129	570	377	110	175	175	395
SY01F30-550 SR3	705	1210	153	129	620	426	110	175	200	420
SY01F35-550 SR3	832	1570	165	149	620	426	140	207,5	170	450
SY01F35-600 SR3	832	1570	165	149	415	508	140	207,5	195	475
SY01F35-700 SR3	832	1570	165	149	772	508	140	207,5	246	526
SY01F40-600 SR3	970	1810	182	176	670	508	170	237,5	165	505
SY01F40-700 SR3	970	1810	182	176	772	530	170	237,5	165	556
SY01F40-800 SR3	970	1810	182	176	878	530	170	237,5	269	609
SY01F48-800 SR3	1130	2355	230	222	878	630	200	280	239	639
SY01F48-900 SR3	1130	2355	230	222	980	730	200	208	290	690
SY01F48-1000 SR3	1130	2355	230	222	1080	730	200	208	340	740
SY01F60-800 SR3	1420	3150	240	225	878	630	270	343	169	709
SY01F60-900 SR3	1420	3150	240	225	980	730	270	343	220	760
SY01F60-1000 SR3	1420	3150	240	225	1080	730	270	343	270	810
SY01F60-1100 SR3	1420	3150	240	225	1180	730	270	343	220	860

TORQUE & DIMENSIONS

SPRING RETURN SR4

TORQUE SHEET

Series	Flange	Output torque air pressure 4 bar			Output torque Springs		
		Air break	Air running	Air end	Spring break	Spring running	Spring end
SY01F14-200 SR4	F14	664	338	424	672	343	432
SY01F14-250 SR4		1045	525	644	1068	538	667
SY01F14-300 SR4		1529	785	1005	1462	744	939
SY01F16-250 SR4	F16	1332	684	873	1268	644	810
SY01F16-300 SR4		1869	953	1207	1877	958	1215
SY01F16-350 SR4		2585	1314	1629	2569	1297	1613
SY01F25-350 SR4	F25	3161	1689	2071	2966	1502	1876
SY01F25-400 SR4		4071	2086	2659	3920	1993	2509
SY01F25-450 SR4		5358	2722	3421	4905	1451	2969
SY01F30-450 SR4	F30	6396	3196	3912	6266	3115	3782
SY01F30-500 SR4		7746	3863	4715	7850	3927	4820
SY01F30-550 SR4		9439	4661	5923	9281	4766	5766
SY01F35-550 SR4	F35	11945	5928	7178	12174	6070	7406
SY01F35-600 SR4		14212	7111	8725	14305	7169	8818
SY01F35-700 SR4		19913	10039	12468	18878	9396	11434
SY01F40-600 SR4	F40	17796	8173	11769	16195	8837	10169
SY01F40-700 SR4		24534	12830	16853	21212	10770	13529
SY01F40-800 SR4		31146	15856	20001	29715	14969	18569
SY01F48-800 SR4	F48	37871	19223	24985	33506	16779	20619
SY01F48-900 SR4		45220	22915	28696	45331	23111	28806
SY01F48-1000 SR4		56544	28261	34618	56775	28403	34848
SY01F60-800 SR4	F60	51399	25952	32316	46647	23006	27564
SY01F60-900 SR4		62058	30761	37173	62764	31199	37878
SY01F60-1000 SR4		74655	37838	45290	78089	38658	48725
SY01F60-1100 SR4		91694	45276	54357	94932	47283	57595

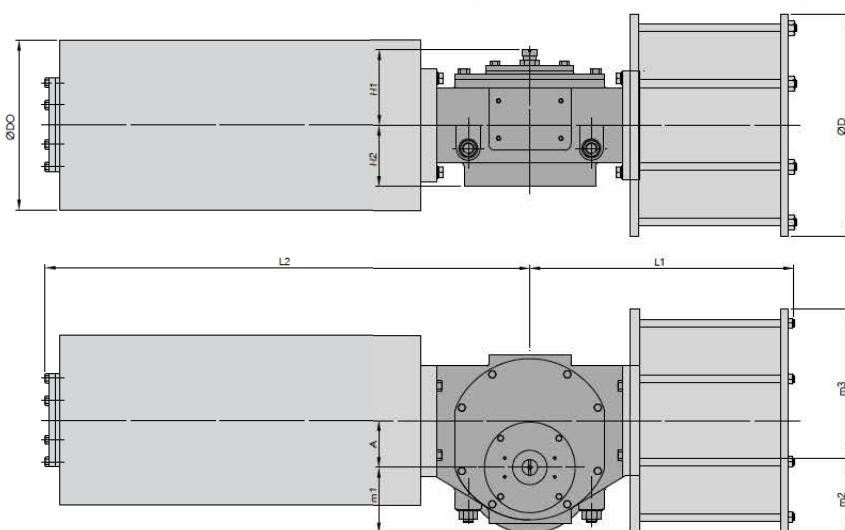
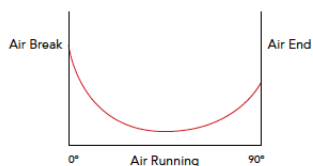

DIMENSIONS

Series	Dimensions in mm									
	L1	L2	H1	H2	Ø D	Ø DD	A	m1	m2	m3
SY01F14-200 SR4	423	618	114	87	256	219	60	89	68	188
SY01F14-250 SR4	423	618	114	87	310	273	60	89	95	215
SY01F14-300 SR4	423	618	114	87	365	273	60	89	122,5	242,5
SY01F16-250 SR4	499	775	119	98	310	273	75	105	80	230
SY01F16-300 SR4	499	775	119	98	365	273	75	105	107,5	257,5
SY01F16-350 SR4	499	775	119	98	415	325	75	105	132,5	282,5
SY01F25-350 SR4	582	935	130	104	415	325	90	150	117,5	297,5
SY01F25-400 SR4	582	935	130	104	465	325	90	150	172,5	322,5
SY01F25-450 SR4	582	935	130	104	516	325	90	150	168	348
SY01F30-450 SR4	705	1210	153	129	516	426	110	175	148	368
SY01F30-500 SR4	705	1210	153	129	570	377	110	175	175	395
SY01F30-550 SR4	705	1210	153	129	620	426	110	175	200	420
SY01F35-550 SR4	832	1570	165	149	620	508	140	207,5	170	450
SY01F35-600 SR4	832	1570	165	149	670	508	140	207,5	195	475
SY01F35-700 SR4	832	1570	165	149	772	508	140	207,5	246	526
SY01F40-600 SR4	970	1810	182	176	670	530	170	237,5	165	505
SY01F40-700 SR4	970	1810	182	176	772	530	170	237,5	165	556
SY01F40-800 SR4	970	1810	182	176	878	530	170	237,5	269	609
SY01F48-800 SR4	1130	2355	230	222	878	630	200	280	239	639
SY01F48-900 SR4	1130	2355	230	222	980	730	200	208	290	690
SY01F48-1000 SR4	1130	2355	230	222	1080	730	200	208	340	740
SY01F60-800 SR4	1420	3150	240	225	878	630	270	343	169	709
SY01F60-900 SR4	1420	3150	240	225	980	730	270	343	220	760
SY01F60-1100 SR4	1420	3150	240	225	1080	730	270	343	270	810
SY01F60-1100 SR4	1420	3150	240	225	980	730	270	343	220	860

TORQUE & DIMENSIONS

SPRING RETURN SR5

TORQUE SHEET

Series	Flange	Output torque air pressure 5 bar			Output torque Springs		
		Air break	Air running	Air end	Spring break	Spring running	Spring end
SY01F14-200 SR5	F14	868	451	588	781	398	501
SY01F14-250 SR5		1334	664	810	1332	663	807
SY01F14-300 SR5		1889	965	1223	1861	947	1194
SY01F16-250 SR5	F16	1675	872	1139	1537	787	1001
SY01F16-300 SR5		2414	1201	1457	2397	1190	1440
SY01F16-350 SR5		3183	1727	2085	3162	1621	2064
SY01F25-350 SR5	F25	3788	2024	2376	3920	1993	2509
SY01F25-400 SR5		5256	2658	3318	4905	2441	2969
SY01F25-450 SR5		6720	3368	4146	6263	3086	3689
SY01F30-450 SR5	F30	7813	3961	4873	7850	3928	4820
SY01F30-500 SR5		9942	5074	6425	9281	4665	5766
SY01F30-550 SR5		11985	6100	7694	11312	5684	7021
SY01F35-550 SR5	F35	15372	7830	9884,16	14305	7169	8818
SY01F35-600 SR5		18144	8967	10785	18003	8881	10644
SY01F35-700 SR5		25215	12639	15558	23625	11654	13968
SY01F40-600 SR5	F40	21428	10904	13745	21212	10770	13529
SY01F40-700 SR5		29011	14529	17866	29715	14969	18569
SY01F40-800 SR5		40684	21006	27076	35071	17525	21462
SY01F48-800 SR5	F48	44307	22348	27782	45331	22982	28806
SY01F48-900 SR5		57686	28968	35760	56775	28403	34848
SY01F48-1000 SR5		72048	36388	45334	68906	34441	42192
SY01F60-800 SR5	F60	60825	29997	35939	62764	31200	37878
SY01F60-900 SR5		76197	38139	46832	78089	39313	48725
SY01F60-1000 SR5		96629	48336	59292	94932	47283	57595
SY01F60-1100 SR5		115566	59189	75366	111245	56510	71046

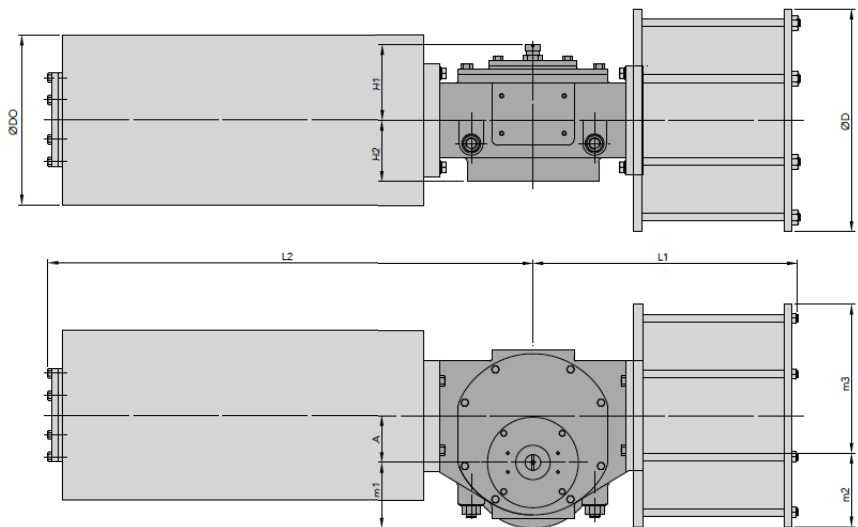
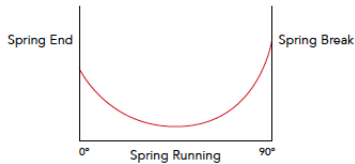
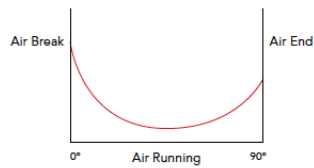

DIMENSIONS

Series	Dimensions in mm									
	L1	L2	H1	H2	Ø D	Ø DD	A	m1	m2	m3
SY01F14-200 SR5	423	618	114	87	256	273	60	89	68	188
SY01F14-250 SR5	423	618	114	87	310	273	60	89	95	215
SY01F14-300 SR5	423	618	114	87	365	325	60	89	122,5	242,5
SY01F16-250 SR5	499	775	119	98	310	273	75	105	80	230
SY01F16-300 SR5	499	775	119	98	365	325	75	105	107,5	257,5
SY01F16-350 SR5	499	775	119	98	415	325	75	105	132,5	282,5
SY01F25-350 SR5	582	935	130	104	415	325	90	150	117,5	297,5
SY01F25-400 SR5	582	935	130	104	465	325	90	150	172,5	322,5
SY01F25-450 SR5	582	935	130	104	516	377	90	150	168	348
SY01F30-450 SR5	705	1210	153	129	516	377	110	175	148	368
SY01F30-500 SR5	705	1210	153	129	570	426	110	175	175	395
SY01F30-550 SR5	705	1210	153	129	620	508	110	175	200	420
SY01F35-550 SR5	832	1570	165	149	620	508	140	207,5	170	450
SY01F35-600 SR5	832	1570	165	149	670	508	140	207,5	195	475
SY01F35-700 SR5	832	1570	165	149	772	630	140	207,5	246	526
SY01F40-600 SR5	970	1810	182	176	670	530	170	237,5	165	505
SY01F40-700 SR5	970	1810	182	176	772	630	170	237,5	165	556
SY01F40-800 SR5	970	1810	182	176	878	530	170	237,5	269	609
SY01F48-800 SR5	1130	2355	230	222	878	730	200	280	239	639
SY01F48-900 SR5	1130	2355	230	222	980	730	200	208	290	690
SY01F48-1000 SR5	1130	2355	230	222	1080	730	200	208	340	740
SY01F60-800 SR5	1420	3150	240	225	878	730	270	343	169	709
SY01F60-900 SR5	1420	3150	240	225	980	730	270	343	220	760
SY01F60-1000 SR5	1420	3150	240	225	1080	730	270	343	270	810
SY01F60-1100 SR5	1420	3150	240	225	1180	730	270	343	320	860

TORQUE & DIMENSIONS

SPRING RETURN SR6

TORQUE SHEET

Series	Flange	Output torque air pressure 6 bar			Output torque Springs		
		Air break	Air running	Air end	Spring break	Spring running	Spring end
SY01F14-200 SR6	F14	1027	513	627	1018	507	617
SY01F14-250 SR6		1632	848	1107	1462	744	939
SY01F14-300 SR6		2257	1144	1433	2268	1150	1443
SY01F16-250 SR6	F16	1998	1033	1335	1877	958	1215
SY01F16-300 SR6		3014	1572	2056	2569	1297	1613
SY01F16-350 SR6		3875	2081	2477	3819	1934	2422
SY01F25-350 SR6	F25	4587	2379	2650	4905	2441	2969
SY01F25-400 SR6		6181	3034	3607	4283	3086	3689
SY01F25-450 SR6		7818	3761	4313	8178	3984	4673
SY01F30-450 SR6	F30	9502	4802	5986	9281	4665	5766
SY01F30-500 SR6		11842	6003	7537	11312	5684	7021
SY01F30-550 SR6		14547	7259	8867	13939	6882	8261
SY01F35-550 SR6	F35	18383	9117	11025	18003	8880	10644
SY01F35-600 SR6		21957	10620	12300	22246	10799	12589
SY01F35-700 SR6		29905	14961	18358	28663	14192	17115
SY01F40-600 SR6	F40	25289	12671	15316	26364	13337	16660
SY01F40-700 SR6		35635	17875	22026	35071	17525	21462
SY01F40-800 SR6		45569	22593	28306	47265	23644	29007
SY01F48-800 SR6	F48	52886	25994	30962	56775	28403	34848
SY01F48-900 SR6		68850	34405	42135	68906	34440	42192
SY01F48-1000 SR6		85632	41828	55235	81853	41326	51456
SY01F60-800 SR6	F60	70017	34123	40354	78089	39313	48725
SY01F60-900 SR6		92311	45658	54974	94932	47283	57595
SY01F60-1000 SR6		114023	58233	73824	111245	56510	71046
SY01F60-1100 SR6	-	-	-	-	-	-	

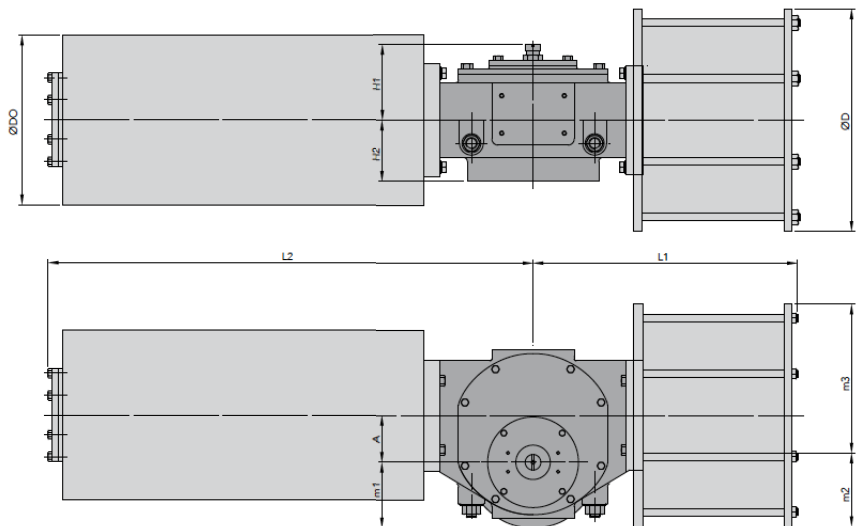
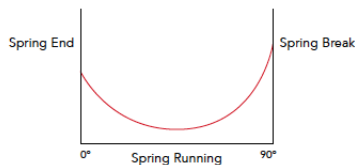
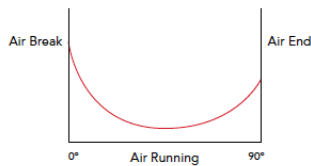

DIMENSIONS

Series	Dimensions in mm									
	L1	L2	H1	H2	Ø D	Ø DD	A	m1	m2	m3
SY01F14-200SR6	423	618	114	87	256	273	60	89	68	188
SY01F14-250 SR6	423	618	114	87	310	273	60	89	95	215
SY01F14-300 SR6	423	618	114	87	365	325	60	89	122,5	242,5
SY01F16-250 SR6	499	775	119	98	310	273	75	105	80	230
SY01F16-300 SR6	499	775	119	98	365	325	75	105	107,5	257,5
SY01F16-350 SR6	499	775	119	98	415	325	75	105	132,5	282,5
SY01F25-350 SR6	582	935	130	104	415	325	90	150	117,5	297,5
SY01F25-400 SR6	582	935	130	104	465	377	90	150	172,5	322,5
SY01F25-450 SR6	582	935	130	104	516	426	90	150	168	348
SY01F30-450 SR6	705	1210	153	129	516	426	110	175	148	368
SY01F30-500 SR6	705	1210	153	129	570	508	110	175	175	395
SY01F30-550 SR6	705	1210	153	129	620	508	110	175	200	420
SY01F35-550 SR6	832	1570	165	149	620	508	140	207,5	170	450
SY01F35-600 SR6	832	1570	165	149	670	630	140	207,5	195	475
SY01F35-700 SR6	832	1570	165	149	772	630	140	207,5	246	526
SY01F40-600 SR6	970	1810	182	176	670	630	170	237,5	165	505
SY01F40 700 SR6	970	1810	182	176	772	730	170	237,5	165	556
SY01F40-800 SR6	970	1810	182	176	878	530	170	237,5	269	609
SY01F48-800 SR6	1130	2355	230	222	878	730	200	280	239	639
SY01F48-900 SR6	1130	2355	230	222	980	730	200	208	290	690
SY01F48-1000 SR6	1130	2355	230	222	1080	730	200	208	340	740
SY01F60-800 SR6	1420	3150	240	225	878	730	270	343	169	709
SY01F60-900 SR6	1420	3150	240	225	980	730	270	343	220	760
SY01F60-1000 SR6	1420	3150	240	225	1080	730	270	343	270	810

OTHER PRODUCTS



RACK & PINION

- Compact pneumatic actuators.
- Aluminium housing.
- Rack and pinion design.
- Up to 6421 Nm.
- ATEX.
- SIL 3.
- CE.
- VDI/VDE 3845.
- ISO 5211.
- EN-15714.



DECLUTCHABLE GEAR BOXES

- Aluminium Housing.
- Rugged construction.
- Sealed to IP-65.
- ACTREG's Actuators direct mounting.
- Compact design-low weight.
- Integral top flange.
- User friendly.
- Double adjustment stroke.



BRACKETS AND COUPLINGS

- Stainless steel, carbon steel or other materials upon request.
- Machined for every kind of valve.



SWITCH BOXES

- Micromechanical switches or inductive switches.
- Inductive switches for direct mounting.
- ATEX execution.
- Feedback and positioner.



PNEUMATIC CONTROL DESIGNS

- Solenoid valves, filters, quick exhaust valves, tubing, regulators...
- Line Break systems.
- Emergency shut down systems.
- Design and manufacturing control cabinets.
- Remote control cabinets.



SPECIAL ACTUATORS

- FIRE-proof.
- Fast acting actuators.
- 100% adjustment stroke actuators.
- Special coatings.
- Special actuators for critical applications.

ACTREG MOBILE APPLICATION

The all-in-one ACTREG interface is a “must have” for the modern automation valve business. Ideal for work, the ACTREG interface can be used to calculate torques with or without safety factors and allows you to make your own configuration with ACTREG actuators. You can also convert any unit of measurement, dimensions, torques, temperatures, and material equivalences from most common standards.

The sleek, easy-to-use interface makes actuator and torque calculations quick and easy. The user-friendly screen interface lets you see items at-a-glance, allowing you to convert quickly while on-the-go.

We have also included some information about ACTREG and the entire product range. This is a highly effective interface made by ACTREG. Anytime, anywhere, and in any situation.



Available on the
App Store



for iPhone
Download now!



Available on the
Google play



for Android
Download now!





ACTREG, S.A.U. (Headquarters)

Carrer de la Ciència, 45-47
08840 Viladecans
Barcelona (Spain)
Phone +34 93 661 44 10
Fax +34 93 654 33 93
actreg@actreg.com

ACTREG do Brasil, Sorocaba (SP)

Avenida Liberdade, 4565
Bairro Iporanga - Sorocaba - SP
CEP 18.087-170
Sao Paulo, Brasil
Phone: 0055 15 3228 1010
Fax: 0055 15 3235 9511
actreg@actregdobrasil.com.br

ACTREG Shanghai Actuator Co. Ltd.

No. 125, Ji Ye Road
SheShan Industrial Zone
Songjiang District, Shanghai, China
P.R.C. 201602
Phone: +86 21 57796818
Fax: +86 21 57792426
sales@jc-valves.net.cn

ACTREG UK, LTD

Units 2 & 3 Henson Close
Telford Way Industrial Estate
Kettering Northants NN 16 8PZ
United Kingdom
Phone: 0044 1536412525
Fax: 0044 1536521616
sales@actreg.co.uk

ACTREG North America

20675 Boul. Industriel
Ste. Anne-de-Bellevue, Québec
H9X 4B2 Canada
Toll Free: 1 800 667 4819
Phone: 001 514 457 5777
Fax: 001 514 457 1348
trueline.sales@trueline.ca

For further information visit our website
www.actreg.com